

711 / 714 / 715 / 716 / 717

Motor terminal boards
similar to DIN 46294

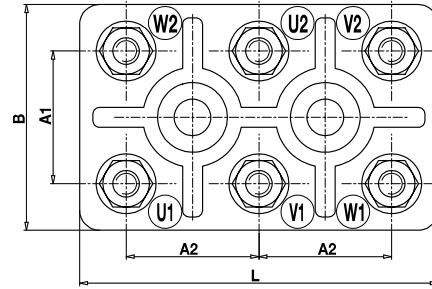
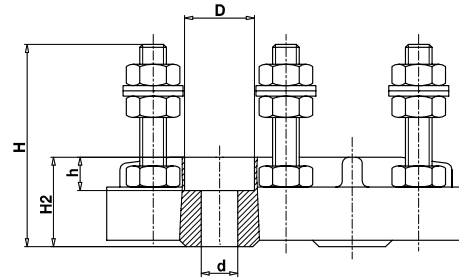

GENERAL INFORMATION

No. of poles	6
Additional Information	Designation of our motor terminal boards in accordance to DIN 46294: 711 = K1 M4 714 = K1 M5 715 = K1 M6 716 = K1 M8 717 = K1 M10

TECHNICAL DATA

Rated Cross Section	Depending upon the cable lugs	
Rated Voltage	max. 660 V Depending on the size and installation conditions, higher voltages can also be applied. The regulations for the dimensioning of clearances and creepage distances must be observed.	
Rated Current	Allowed continuous current for bushing bolt:	711: 16 A 714: 25 A 715: 63 A 716: 100 A 717: 160 A
Torque	711 (M4): 1,2 Nm 714 (M5): 2,0 Nm 715 (M6): 3,0 Nm 716 (M8): 6,0 Nm 717 (M10): 10,0 Nm	
Base mounting	Recommendation: 711: screw M5; Max. torque 1.5 Nm 714: screw M6; Max. torque 2 Nm 715: screw M6; Max. torque 2 Nm 716: screw M8; Max. torque 3 Nm 717: screw M10; Max. torque 3.5 Nm Installation of all variants each with matching washer and use of an elastic & insulating substrate.	
Other specifications	Rated voltage only applies if an insulating substrate is used.	

Dimensions (mm)

Type	LxB	M	H	H2	h	A1	A2	D	d
711	54x34	M4	27,5	13,5	5	20	20	ø 10,5	ø 5,5
714	64x40	M5	31,5	15,5	7	23	23	ø 12,5	ø 7
715	78x48	M6	37,5	18,5	9	28	28	ø 12,5	ø 7
716	96x60	M8	47,5	21	10	35	35	ø 16	ø 9
717	120x75	M10	55	25	15	45	45	ø 18,5	ø 11

MATERIAL

Base material	Technical ceramics
Comparative Tracking Index	CTI ≥ 600
Insulating Group	I
Temperature Range	-40°C up to 250°C
Nut	Brass, blank
Screw	Brass, blank
Washer	Zinc plated steel

OPTIONS / ACCESSORIES

- Jumpers 751-758

CONFIGURATIONS

Item	Article number	PU
711	10.680.011	48
714	10.680.014	30
715	10.680.015	16
716	10.680.016	9
717	10.680.017	9